

DOPPIO

Individual or group
adjustable LED spotlights



Configuration example

DOPPIO

Range	Adjustable luminaire for accent lighting
Description	360° LED spot(s) supplied alone on stud and threaded rod or on support bar for multiple spots Finish: ultra-matt black anodizing
Dimensions	Spotlight: 39x33mm Plot: section 8x8mm Support bar: 260mm for 3 spots - 330mm for 4 spots
LED characteristics	2700K - 3000K - 3000K + 35000K - 4000K (other configurations on request) MacAdam ellipse: 3 SDCM CRI: 90
Optical beam	20° - 30° - Elliptical 25x50
Serial connection	Supplied alone on mounting stud or connected in series with a 1m extension lead with quick connector
Separate power supply	350mA constant current driver
LED power	1.1W/spot at 350mA
Use limitations	The product must be installed into a ventilated area. Any use with an ambient temperature higher than the specified ambient temperature (Ta) would lead to a more rapid mortality of the product and the withdrawal of our guarantees. The drivers, if not delivered by LOuss, must be approved before use.
Warranty	Life span: L80B10 at 50,000 hours (80% remaining flux) at 25°C ambient temperature. 3-year parts and labour warranty. The warranty does not apply to products that have been opened, modified or repaired and does not cover the effects of a wrong connection, careless, abusive handling, overvoltage, lighting injury, as well as the normal wear of the product. All products are electrically tested and received a functional burn-in.

All the connections have to be made before powering up, otherwise the luminaire could be seriously damaged.

LOuss

Last update : 18/07/2024

Firalux & LOuss brands

SARL, Capital 40 000€
RCS DIJON B 503 367 245
TVA/VAT n°: FR24 503 367 245
APE 4676Z

Tel. : +33 380 48 65 68
contact@louss.fr
www.louss.fr
Best group

Siège social / Head Office
PA Les Terres d'Or
Route de Saint Philibert
21220 Gevrey Chambertin - FRANCE

DOPPIO SOLO

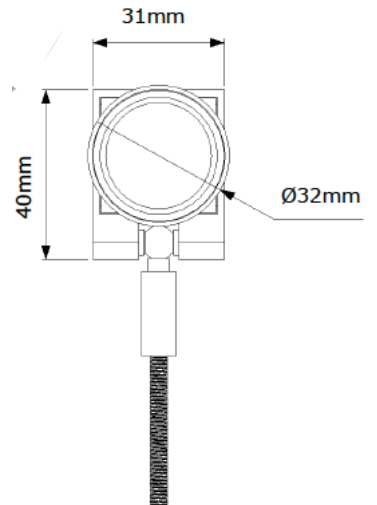
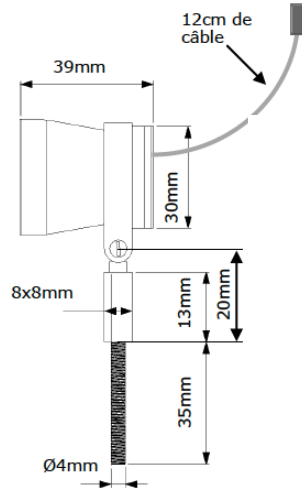

DOPPIO ON BAR

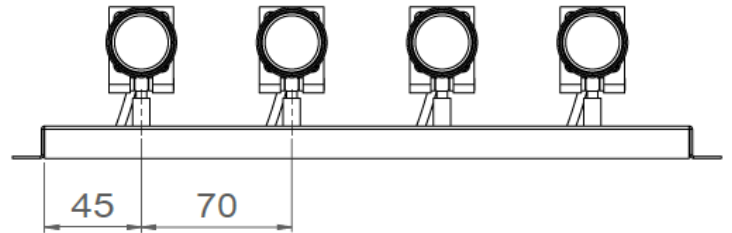
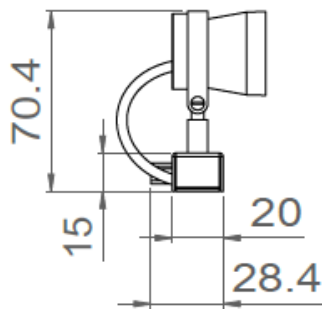
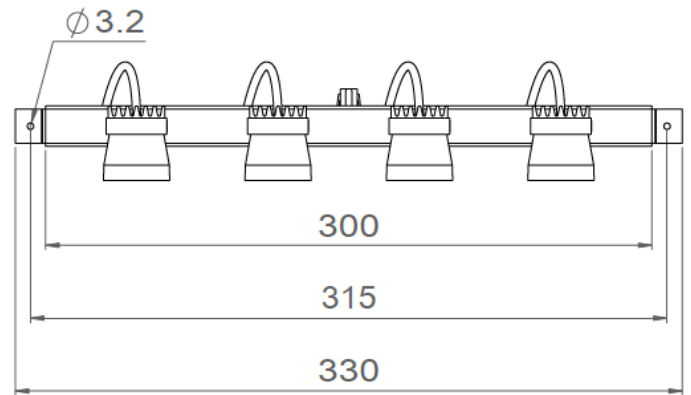
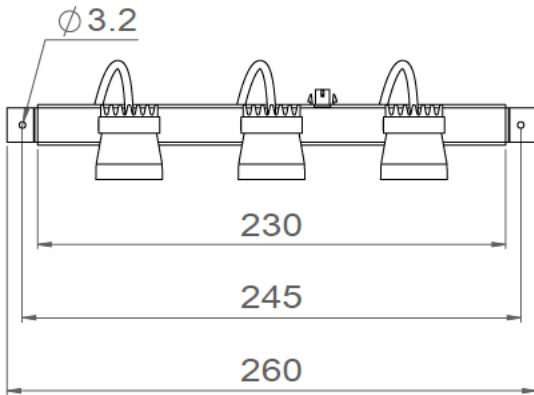

All the connections have to be made before powering up,
otherwise the luminaire could be seriously damaged.

LOUSS

Last update : 18/07/2024

Firalux & LOUSS brands

SARL, Capital 40 000€
RCS DIJON B 503 367 245
TVA/VAT n°: FR24 503 367 245
APE 4676Z

Tel. : +33 380 48 65 68
contact@louss.fr
www.louss.fr
Best group

Siège social / Head Office
PA Les Terres d'Or
Route de Saint Philibert
21220 Gevrey Chambertin - FRANCE